

Ordering instructions

The complete AMV-ITK termination kit comprises the following components:

AMV-ITK 24



3 x Silicone tube*

=

3 x AMV-I-ITK termination kit**

* Factory pre-assembled silicone tubes comprising stress relief and sealing mastic.
** Also comprises sealing mastic and installation instructions.

Termination type	Voltage Um (kV)	Strike distance L (mm)	Dia. over core insulation (mm)	Conductor sections Al or Cu (mm ²)	
				min.	max.
AMV-I-ITK 24.2	24	260	14...33	25	240
AMV-I-ITK 24.3	24	300	30...50	300	800

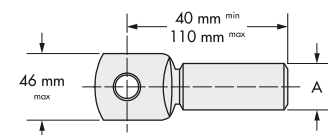

- ① A cable lug (not supplied in the standard kit).
- ② Sealing mastic.
- ③ A silicone tube.
- ④ Stress relief material.
- ⑤ A conductive EPDM ring.

Cable lugs should be within the dimensions specified (not applicable for AMV-ITK 24.3). In other cases, refer to our local representative.